

aloft
NEW DELHI AEROCITY

aloft
HOTELS

ALOFT NEW DELHI AEROCITY

Different. By design

aloft
HOTELS



HOTEL OVERVIEW

ALOFT NEW DELHI AEROCITY

Explore the vibrant, sassy and stylish attributes of the capital city by sojourning at the distinct world of Aloft New Delhi Aerocity. The exuberant ambience of this property with 253 bright and breezy guest rooms illustrates the ideal combination of contemporary and futuristic infrastructure.

Strategically located in Aerocity that is accessible to all major touchpoints of the city alluring both local and international Self Expressers by providing them global cuisines at its well-designed dining venues.

Offering a variety of dining and leisure options to make your stay relaxed and comfortable with customized event solutions and seamless service for your meetings and events.

Get busy in one of our function venues and tactic meeting spaces, and add some pizzazz to your next social soiree or business bash. Each Tactic Room is outfitted with the best A/V set up, including a Large Format Display (LFD) screens.

HOTEL OVERVIEW

LOCAL ATTRACTIONS

INDIA GATE



QUTUB MINAR



BANGLA SAIB GURUDWARA



KINGDOM OF DREAMS



DILLI HAAT



CYBER HUB

ACCOMODATION



ACCOMODATION

ROOM TYPES

Category	Room Size	Count
Aloft Room	30 Sq. Mt	134
Premier Room (Pool Facing)	30 Sq. Mt	47
Club Room	30 Sq. Mt	57
Aloft Studio	37 Sq. Mt	12
Aloft Residences	70 Sq. Mt	3
Total		253

ACCOMODATION

ROOM

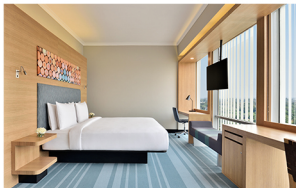

MEETINGS & CONFERENCES



MEETINGS & CONFERENCES

EVENT SPACES

Banquet Venues	Dimensions	Area (Sq. ft.)	Boardroom	Theatre	Class Room	Conference	U-Shape	Reception	Cocktails
	L x W x H								
Tactic 1/2	68 x 40 x 15.6	2730	60	275	135	120	51	90	250
Tactic 1	40 x 34 x 15.6	1360	36	84	60	50	33	40	X
Tactic 2	40 x 34 x 15.6	1360	36	84	60	50	33	40	X
Tactic 3/4	34 x 18 x 9	650	24	X	X	X	X	X	X
Tactic 3	17 x 18 x 9	320	10	X	X	X	X	X	X
Tactic 4	17 x 18 x 9	320	10	X	X	X	X	X	X
Tactic 5	25 x 16 x 9	400	14	X	X	X	X	X	X
Tactic 6	34 x 18 x 9.5	612	24	X	X	X	X	X	X
Tactic 7	22 x 12 x 9.5	264	12	X	X	X	X	X	X
Tactic 8	13 x 11 x 9.5	143	12	X	X	X	X	X	X
Terrace	64 X 34	2176	X	X	X	X	X	X	100

The image shows the interior of a restaurant or bar. On the left, there is a long bar with a white countertop and a dark wood base. Behind the bar, shelves are filled with various bottles of liquor. The walls are covered in a dense, floral-patterned wallpaper. Several small, framed pictures are hanging on the wall. In the foreground, there are several wooden chairs with light-colored upholstery. A small table with two chairs is visible in the background. The ceiling is a solid teal color, and several pendant lights with brass-colored shades hang from it. The floor is made of light-colored wood. The text "FOOD & BEVERAGE" is overlaid in white capital letters on a dark blue rectangular background.

FOOD & BEVERAGE

NOOK



DINING VENUES

Outlet	Cuisine	Hours	Setup
The Nook	Indian & International	24 Hours	Modern cozy sit-down dining
W XYZ The Lobby Bar	Soft Beverages and Snacks	12:00PM to 01:00AM	Lively and abuzz lobby bar
Re:fuel by Aloft SM	Patisserie	24 Hours	Easy breezy 'Grab & Go'
Splash Pool Side	Soft Beverages and Snacks	6:30AM to 08:00PM	Soak up the sun while enjoying Snacks and Soft Beverages

RECREATION

RE:CHARGE & SPLASH



Re:chargeSMgym

Equipment	Life Fitness
Equipment Type	Cardio and Free Weight
Free Weight	Yes
Hours	24 Hours
Yoga	Yes

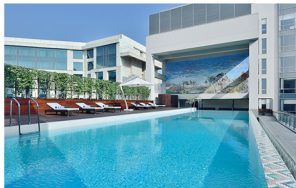

Splash outdoor pool

Maximum Depth	1.22 meters/4.0 feet
Minimum Depth	1.22 meters/4.0 feet
Size	125.88 sq. meter/ 1355.00 sq. feet
Hours	06:30 AM- 08:00 PM



LIVE. LIFE. ALOFT